



**Presents**  
***Maria Layne***



**120' (36.6 m) SOVEREIGN Motor Yacht**

## Maria Layne



### 120' (36.6 m)SOVEREIGN

<b>LOA:</b>	120' (36.6 m)	<b>Year:</b>	Mfg-2000 Model-2000
<b>LWL:</b>	110' (33.5 m)	<b>Mfg:</b>	SOVEREIGN
<b>Beam:</b>	25' (7.6 m)	<b>Model:</b>	Motor Yacht
<b>Draft:</b>	Min 6' (1.8 m)	<b>Type:</b>	Motor Yacht with cockpit
<b>Clearance:</b>		<b>Staterooms:</b>	5
<b>Hull Mtrl:</b>	Fiberglass	<b>Fuel Cap:</b>	8000 g (30280 l)
<b>Designer:</b>	Jack Sarin	<b>Water Cap:</b>	1000 g (3785 l)
<b>Range:</b>	3000	<b>Engines:</b>	2xDetroit Diesel 16V2000
<b>Flag:</b>	Cayman	<b>Speed:</b>	<b>Cruise</b> 18 knots / <b>Max</b> 24 knots
<b>Location:</b>	Fort Lauderdale, Florida, United States	<b>Price:</b>	7,900,000 USD

## Main Salon



There is a Frigidaire 26 bottle wine cooler located in the Saloon. Formal Dining in Saloon that seats eight. Main Saloon Forward Buffet Stone Selection - Amarillo gold with (2) 14" bullnose that is also used for a 44" top for game table.

## Galley



The Galley allows dining for eight for informal meals. Galley flooring is cherry with maple rim border. Galley wallcovering is Innovations Alchemy Suede (straw colour), countertops and splash is Corian white and the light fixtures are Vimar chrome finish. There is a SubZero or Thermadore double door refrigerator/freezer, Jennair 4-burner cook top, Sharp microwave, Whirlpool dishwasher, Braun trash compactor and garbage disposal. Laundry wallcovering is Phillip Jeffries textured cream, ceramic tile flooring, Corian counter tops (Sandstone Sierra) , gold finish switches, latches and plates. Frigidaire washer/dryer combo in laundry room.

## Pilothouse



Two STIDDS leather chairs and leather companion couch aft RCL-100 remote spotlight Northstar GPS 941X ICOM VHF M59 Simrad EQ 40/50 Echo Sounder Simrad 40//50 Chart Radar and Echo Sounder 48-mile Starboard side chart lockers and chart table Full electric sub panel SIS Alarm System Simard AP20 Autopilot with angle rudder indicator and heading plus full navs Furuno 207 Weatherfax with Nav Tecs Naiad Multi Sea 2000 Stabilisers - 9' Sea Hail - Hailer ICOM IC-710 VHF Transceiver ICOM IC-M127 VHF Panasonic KX-T7433 Telephone Simrad Sat Com Motorola Cell Phone Elbex CCT Black and White Television Five windshield wipers and washers Dataline wind indicator (speed and direction) Jastrum angle rudder indicator AC and DC Power Steering plus manual steering Electronic jog control and steering Sub Zero Refrigerator/Freezer U-line Ice Maker Sink located aft and to port Head and Captain's Quarters to starboard and radius doors Wing controls Suede couch and love seat Glass rack

## Foyer



Lower and Main Deck Foyer has Silk Dynasty Impressions wallcovering, stone flooring with Breccia Oniciata with water-jet cut pattern per designer Pacific Custom Interiors (PCI), gold finish light fixtures and Vimar switch plates.

## **Master Stateroom**



The on deck Master Stateroom has wall covering Silk Dynasty Impressions, carpet flooring, and gold finish latches. The master head has a Kohler sink undermount, Jado - silver nickel gold finish faucet, shower stall OTM 1185, stone flooring OTM 1185, stone counter top and TubDeck OTM 1185, backsplash OTM 1185, Vimar gold finish switch plates push button latches, Majilite headliner material and Sealy mattresses. Separate DSS receiver in the master stateroom.

## **Master Head**



## **VIP Stateroom**



Wallcovering is a textured tan, carpet flooring, Vimar gold finish latches and switch plates. Features Queen bed with ensuite head. His and closets provide more than ample closet space. Additional storage can be found under bed and custom cabinets along port wall.

## **VIP Stateroom 2**

Wallcovering is a textured tan, carpet flooring, Vimar gold finish latches and switch plates. Features Queen bed with ensuite head, settee, two nightstands, complete entertainment centre, ample closet space and marble sink tops. His and her closets provide more than ample closet space with additional storage below bed and custom storage along starboard wall.

## **Guest Stateroom**

Wallcovering is a textured tan, carpet flooring, Vimar gold finish latches and switch plates. Features Queen bed with ensuite private head and shower, settee, complete entertainment centre, his and her nightstands and marble sink tops.

## **Forward Stateroom**



Wallcovering is a textured tan, carpet flooring, Vimar gold finish latches and switch plates. Features a total of four single berths, private head and shower with stone counter tops and private entertainment centre.

## **Forward Stateroom**

Wallcovering is Phillip Jeffries textured cream, carpet flooring, Vimar gold finish latches and switch plates. Sleeps four, private head and shower and stone counter tops. Also features complete laundry facilities washer/dryer, full stainless steel 6' freezer, crews emergency escape hatch, watertight doors and bulkhead. This area may also double as additional crews quarters, with its private access crew can remain isolated.

## **Heads**

Day Head counter top is stone – Asian black and gold slab 1 ½" bullnose with same back splash. Flooring is Asian black and gold stone. Gold finish Bates and Bates undermount sink. Silver nickel and gold finish faucet by Jado. Switch plates are Vimar gold (Rondeau).

Guest heads have a Syntex rose beige textured wallcovering, stone flooring Breccia Oniciata 12' x 12" tiles, counter tops are Breccia Oniciata slab with 1 ½" bullnose, splash is Breccia Oniciata 12" x 12" tiles with water-jet cut pattern in light emperador, chrome finish switches and latches, Kohler Vintage undermount sink, Jado faucet silver nickel finish, and Breccia Oniciata tile above shower stall.

## Crew Quarters



Crew Quarters (Captains and Crew stateroom) has Syntex cream wallcovering, carpet flooring, grey/blue sheetrock, chrome finish switch plates and latches. The Crew Head has Syntex cream wallcovering, ceramic tile flooring, Corian countertop (Sandstone Sierra), chrome finish latches and switch plates, Grohe chrome faucet, Kohler bolero stainless sink and chrome shower door hardware. Majilite headliner material and Sealy Mattresses. 74 cubic foot walk-in freezer in forward crew cabin.

## Skylounge



The skylounge has a high standing settee/wetbar, ideal for guests to enjoy the company and scenery. The tri-level layout offers a stunning sky lounge with wet bar and sofas allowing guests, captain and crew to socialize while cruising and running the boat. There is even another stateroom perched on this upper level for whomever deserves the post of command.

## Lazarette

- (3) Inverters 4000 VA
  - (2) Shore Power Transformers
  - (2) Shore Power Controllers
  - (2) 100 Shore Cables and Glendinning Cable Master
- Transom Door

## Cockpit



Teak Inlay  
Custom Storage Cabinets  
8 Rod Holders  
Transom Door  
Hot / Cold Shower  
Live Bait Tank 80 Gallon  
Pasarelle  
Manual Integral Swim Platform

## Electrical System

PLC controlled power distribution system - generators and PLC can be controlled from the wheelhouse.

Ocean multiple voltage shore power conditioner allowing 50 or 60 hertz operation at a variety of input voltages. Full alarm system: fire and smoke, burglary alarm, security TV monitors, bilge level alarms. Battery Charging - house batteries - inverter charger, engine start batteries - two bank 80 amp charger and engine alternators, emergency bridge batteries - 10 amp charger. Battery storage and ventilation - batteries are stored in acid proof containers well fastened down. Engine room mounted batteries are ventilated through the engine air ventilation system. Batteries outside of the engine room space are ventilated to open air. Bonding - all metals in contact with sea water are connected to a 1" by 1/8" copper bar running the length of the vessel which is connected to the sacrificial zinc anodes at the stern of the vessel. Emergency batteries - 12 volt 100 amp hour located on the flybridge. Engine batteries - two banks of (2) 8D batteries each located in the engine room one bank per engine, interchangeable. Generator batteries - one bank of (2) 8D batteries. House batteries - one bank of (12) 2 volt cells providing 1200 amp/hours of power. (3) 24-volt Battery Chargers (3) Inverters - Trace 4000 watt c/w 120 amp charger. Isolation Transformers - (2) 25KVA transformers one connected to each shore power input to prevent electrolytic corrosion and increase safety. Ships grounding - ships AC ground is attained via a copper ground plate mounted on the outside of the hull to provide adequate contact with the sea water. Ships status panel - on pilothouse, this panel indicates the operation of all the bilge pumps, as well as the navigation lights and various pumps.

## **Flybridge**



Bimini Top for flybridge.



## **Jazuzzi**



## **Other Features and Equipment**

Fire hydrants extensively throughout vessel All fire extinguishers current FMS200 Fire suppression in lazarette and engine room, Patent 8 automatic, supervised control panel One Novurania 530 tender c/w 115 hp Yamaha 4-stroke One 10' inflatable c/w 15 hp Yamaha 2-stroke Four liferafts (all current) two 6-person and two 4-person 2500 lb. davit Nautical Structures Nautical Structures EX 3000 deck crane All exterior doors by Pacific Coast Marine ABS approved portholes complete with solid "deadlight" covers Frameless windows throughout Complete compliment of safety equipment Large walk-in freezer Extensive electronics and navigational package All Staterooms equipped with full entertainment systems Multi-standard televisions in each stateroom, salon, pilothouse, linked to Sea-Tel 2494 with TAC-92 antenna controller Stereo in each stateroom, salon and pilothouse Telephone Intercom system throughout vessel - Panasonic combination telephone/intercom Ships ventilation systems - each area aboard the ship is provided with a positive pressure fresh air ventilation system to minimise dampness and odours Carpets - sound absorbing padding provides a luxurious as well as functional backing for the high quality carpeting that covers all areas of the yachts interior flooring with the exception of the heads and galley Gold finish light fixtures throughout vessel and there are some rooms

that are accented in chrome

## **Engine /Mechanical Equipment**



Twin 16V2000 Detroit / MTU Diesel Engines, 1800 HP each @ 2300 RPM (2500 hours) Transmissions: Twin-Disc 6557DC, electronic control with manual back-up Generators: One Northern Lights 65kw, 120 / 240, 60Hz @1800 rpm and One Northern Lights 50kw, 120 / 240, 60Hz @ 1200 rpm Dual Ocean Electro multi-voltage shore power controllers with two 100' cables, Glendinning Cablemaster Alfa-Laval MIB303 fuel oil purifier Bow thruster 16" American Bow Thruster 60 hp, Trac series Naiad 353 Stabiliser system Sea Recovery SRC 1500-2 SRC R/O Watermaker, 1500 USG a day Three SW4024 Trace

Inverters, 4000VA Underwater exhaust Lube oil change system for complete change of all machinery five blade skewed tip Teinbridge propellers Jastram electric over hydraulic steering Wheelhouse, flybridge and (4) wing control stations 20 ton Aqua Air airconditioning system. Each zone has its own air handler, each being isolated with ball valves for individual servicing. The compressors, located in the engine room, operate in succession coming on line only as needed. For drainage of the units, schedule 40 PVC piping hose bibs are located in the engine room and forward bilge. Heat is provided by heat strips (electric) in each air handler. Fully heat and ventilated (make up air) Water Heating - heated by two 40 gallon, 220 volt hot water heaters. Equipped with a 110 volt AC circulation pump providing non-delay hot water at each hot water outlet. Water pressure pumps - Two Head Hunter electric jet pumps (one is back-up) at between 40 to 60 psi. Includes two surge tanks. Dual sea chests for all salt water requirements - located in engine room. Each chest is engineered to have (5) times the necessary capacity to operate all of the cooling functions associated with the system.

The top of the sea chests are Lexan Polycarbonate which are removable to access the non-corrosive, low maintenance polymer screen. These screens may be serviced while the yacht is underway. Head Hunter toilets - vacuum pump heads discharging into the vessels holding tank Hayden central vacuum system 500 gallon black water tank Anchor washdown Two independent anchor systems 400' chain 5/8", 390 lb Davis anchors, stowed in stainless steel hull side anchor pockets Two Muir anchor winches 4500 lb Two Stern Capstans - Muir 2000 lb capstan for docking High efficiency engine room sound insulation

## **Hull**

The Airex cored hull has a better impact resistance than most composites, formed with two layers of resin-impregnated, closed cell Airex separated and sandwiched between inner and outer skins of solid fibreglass. But the house is a Corecell composite with higher general strength to weight ratio. Nidacore is used for lighter, non-structural bulkheads.

## Bow



---

Richmond Yachts

2121 NW 55th Court- Suite 10 Ft lauderdale, Florida 33309 United States  
Phone: +1.954.689.9248, Email: richmondyachts@aol.com  
URL: [www.richmondyachts.com](http://www.richmondyachts.com)

***Maria Layne***

5/1/2007

Page 11

**Starboard Side**



---

Richmond Yachts

2121 NW 55th Court- Suite 10 Ft lauderdale, Florida 33309 United States  
Phone: +1.954.689.9248, Email: richmondyachts@aol.com  
URL: [www.richmondyachts.com](http://www.richmondyachts.com)

***Maria Layne***

**5/1/2007**

**Page 12**

## Layout

SOVEREIGN 120'

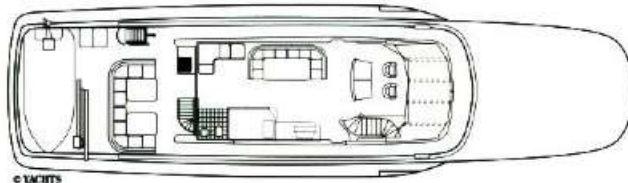

© YACHTS

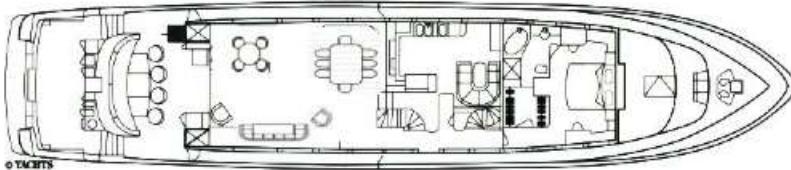

© YACHTS

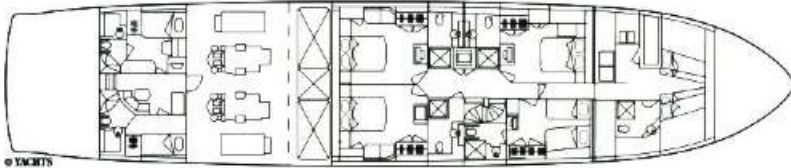

© YACHTS

YACHTS

### TECHNICAL SPECIFICATIONS

LOA : ..... 121'  
LWL : ..... 110'  
Beam : ..... 25'  
Draft : ..... 6'  
Construction Materials : ..... Composite  
Fuel Capacity : ..... 8,000 gals  
Maximum Speed : ..... 24 knots  
Cruising Speed : ..... 18 knots  
Range : ..... 3,000 n.m.  
Power : ..... 2 x Detroit Diesel 16V2000  
Builder : ..... Sovereign Yachts

Richmond Yachts

2121 NW 55th Court- Suite 10 Ft lauderdale, Florida 33309 United States  
Phone: +1.954.689.9248, Email: richmondyachts@aol.com  
URL: www.richmondyachts.com

*Maria Layne*

5/1/2007

Page 13

## Layout

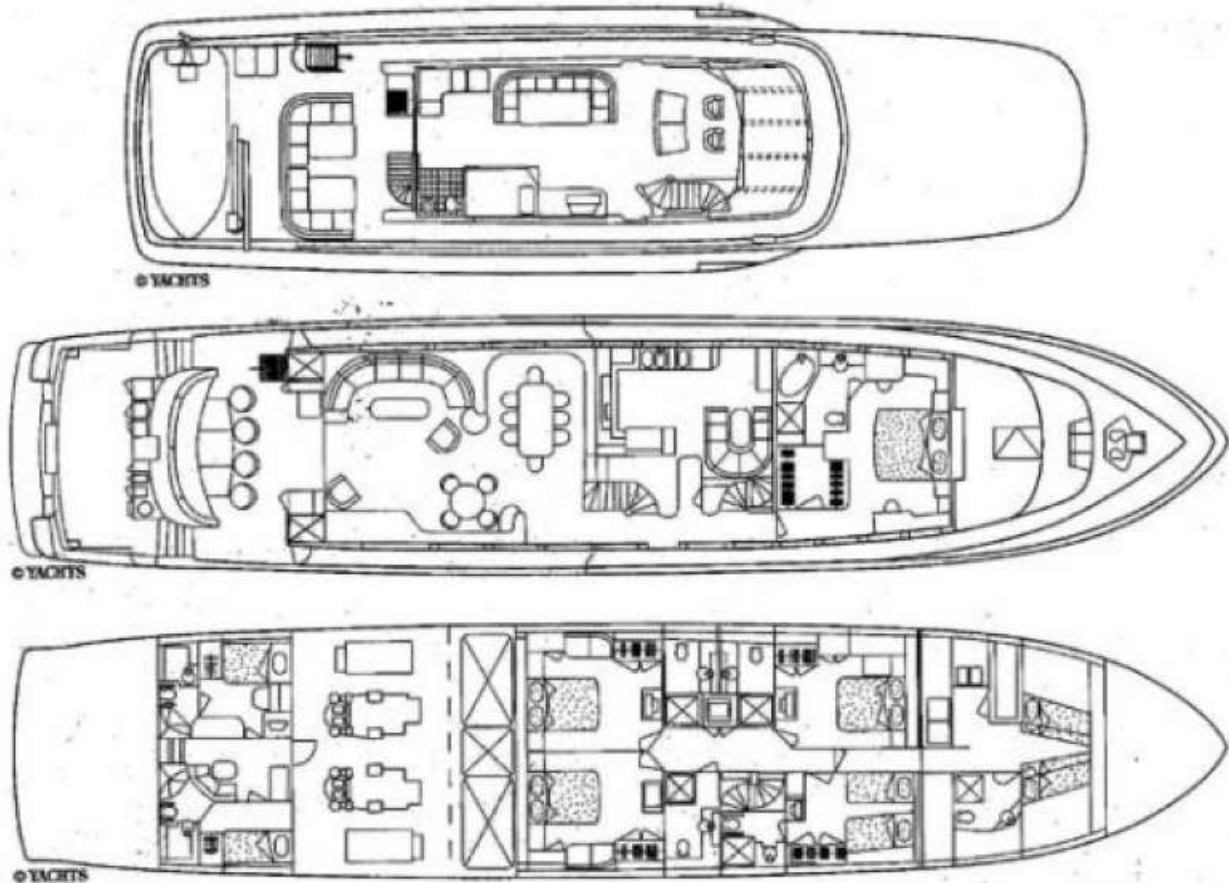

Richmond Yachts

2121 NW 55th Court- Suite 10 Ft lauderdale, Florida 33309 United States  
Phone: +1.954.689.9248, Email: richmondyachts@aol.com  
URL: www.richmondyachts.com

*Maria Layne*

5/1/2007

Page 14